

SEC.A-A

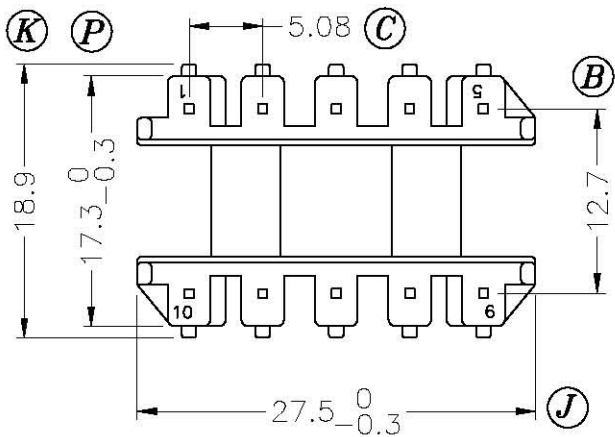
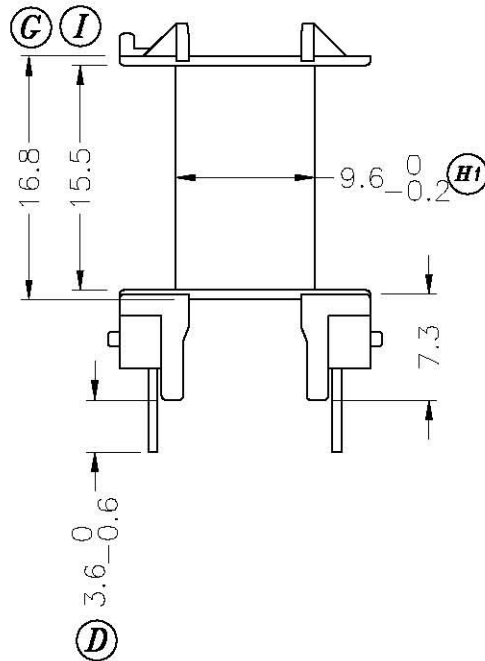
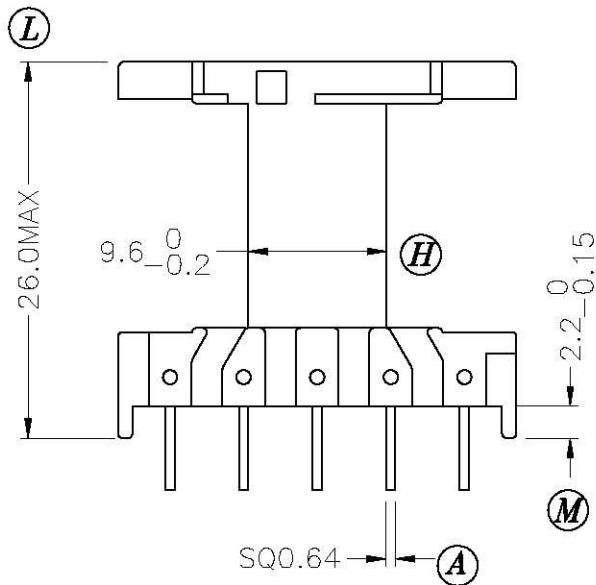

REV.	REVISIONS REC.	REV.	REVISIONS REC.

DRAWN & DRAFTED BY WU FANG	TOLERANCES		ANGLE: $\pm 1^\circ$	TITLE: EF-25	
	0 < L ≤ 4 ±0.1	pin pitch ±0.2	UNIT: MM	BOBBIN MATERIAL: PA66 A3X2G7	UL REC. UL 94V-0
CHECKED & APPROVED BY	4 < L ≤ 16 ±0.2	16 < L ≤ 63 ±0.3	ORIGIN: SZ	PIN MATERIAL: CP WIRE	PIN TENSION LOAD: 1.5KG MIN
PIN SHINE INDUSTRIAL CO., LTD. TEL: 886-2-22990545 FAX: 886-2-22990546			DATE: JAN.09 '2003	DRAWING NO. P-2549	REV. 0