

Dimension: (UNIT:mm)

A	54.5 ± 1.3
B	18.9 ± 0.4
C	27.6 ± 0.2
D	20.2 ± 0.4
E	40.1Min
F	18.9 ± 0.4
G	
H	

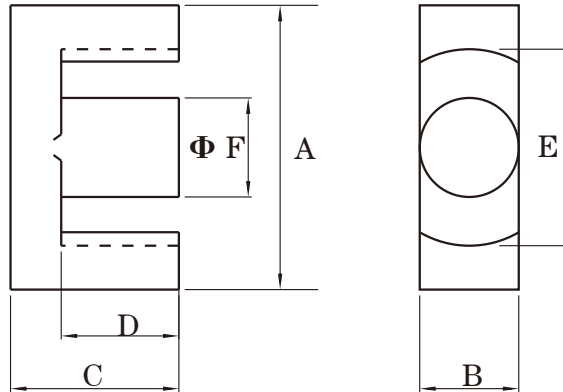

Test conditions

AL: F=1.0KHz U=0.3V N=10Ts

Effective parameter

C1(mm) ⁻¹	Ae(mm ²)	Le(mm)	Ve(mm ³)	Weight(g)
0.454	280	127	35500	≈90

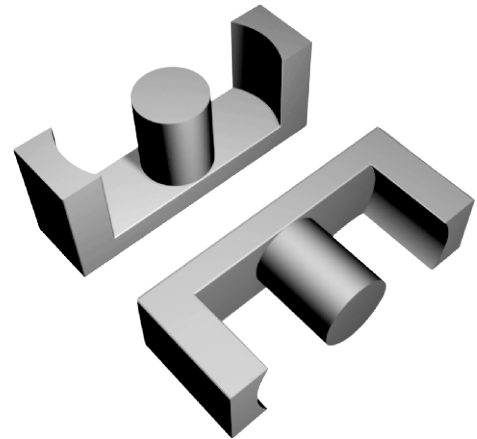

Core halves.

Clamping force for AI measurements, 70+/-20N.
gapped cores are available on request.

Grade	AL (nH)	μe	AIR GAP μm	Type number
P3	5000 ± 25%	≈ 1810	≈ 0	ETD54-P3
P4	5000 ± 25%	≈ 1810	≈ 0	ETD54-P4
HQ2K	4600 ± 25%	≈ 1660	≈ 0	ETD54-HQ2K

Properties of core sets under power conditions

Grade	B (mT) at		Core loss (w) at		
	H=250 A/m F=25KHz T=100°C	F=25 KHz B=200mT T=100°C	f=100 KHz B=100mT T=100°C	F=100 KHz B=200 mT T=100°C	F=400 KHz B=50mT T=100°C
P3	≥330	≤ 4.3	≤ 4.8	-	-
P4	≥330	-	≤ 3.6	≤ 21	-
HQ2K	≥320	-	≤4.5	-	≤ 8.5

Note:

- 1: Document is the property of FUAN Inc & is not allow to be duplicated without authorization
- 2: RoHS compliant.