

**Dimension: (UNIT:mm)**

A	48.7 ± 1.1
B	16.7-0.6
C	24.7 ± 0.2
D	17.7+0.8
E	36.1Min
F	16.7-0.6
G	
H	

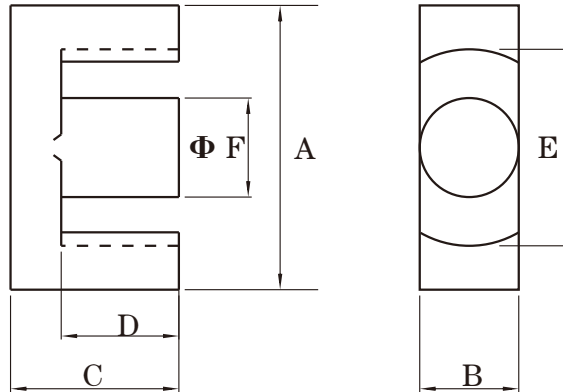

**Test conditions**

AL: F=1.0KHz U=0.3V N=10Ts

**Effective parameter**

C1(mm) <sup>1</sup>	Ae(mm <sup>2</sup> )	Le(mm)	Ve(mm <sup>3</sup> )	Weight(g)
0.534	211	114	24000	≈62

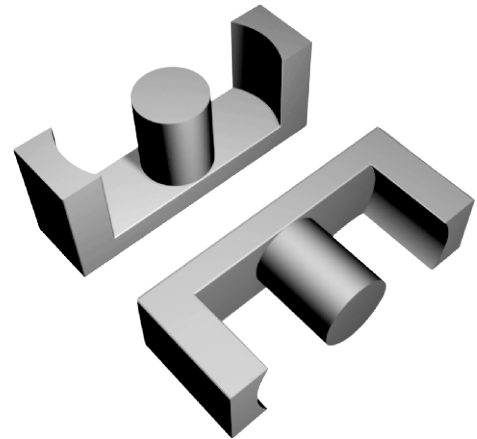

**Core halves.**

Clamping force for Al measurements, 50+/-20N.  
gapped cores are available on request.

Grade	AL (nH)	$\mu e$	AIR GAP $\mu m$	Type number
P3	4200 ± 25%	≈ 1810	≈ 0	ETD49-P3
P4	4200 ± 25%	≈ 1810	≈ 0	ETD49-P4
HQ2K	3900 ± 25%	≈ 1680	≈ 0	ETD49-HQ2K

**Properties of core sets under power conditions**

Grade	Core loss (w) at				
	B (mT) at H=250 A/m F=25KHz T=100 °C	F=25 KHz B=200mT T=100 °C	f=100 KHz B=100mT T=100 °C	F=100 KHz B=200 mT T=100 °C	F=400 KHz B=50mT T=100 °C
P3	≥ 330	≤ 2.9	≤ 3.1	-	-
P4	≥ 330	-	≤ 2.3	≤ 12.4	-
HQ2K	≥ 320	-	≤ 3.0	-	≤ 5.4

**Note:**

- 1: Document is the property of FUAN Inc & is not allow to be duplicated without authorization
- 2: RoHS compliant.